

MF-230 SERIES - MEDIUM FLOW PRESSURE REGULATOR WITH SENSITIVE ELASTOMERIC DIAPHRAGM

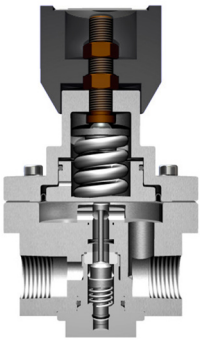

SPECIAL FEATURES

- 316L SS Machined Wetted Parts
- Large sensitive elastomeric diaphragm
- 0.1bar to 10bar / 1.5psi to 150psi control range
- Minimal decaying inlet pressure effect
- For flow rates to 240Nm³/hr (@ max P2)

TECHNICAL DATA

Max rated inlet pressure	230bar (3300psi)
Max outlet ranges	Diaphragm: 10bar (150psi)
Body and trim	316 St St.
Leakage	Bubble tight to ANSIFCI 70-3-2004
Seat diameter	7.2 mm
Weight	Approx 1.7kg

STANDARD MATERIALS OF CONSTRUCTION

Body and Bonnet	316SS
Seat	PCTFE
Diaphragm (P2 max 10bar)	Extreme Viton
Handwheel	Nylon
Spring rests	316SS
'O' ring seals	FKM
Adjusting screw	Ali Bronze
Loading Spring	Spring Steel
Lubricant	Krytox GPL 205

NOTE: Product availability and specifications contained herein are subject to change without notice. Consult local distributor or factory for potential revisions and/or service related issues.

ORDER CODE

Basic Model	Cv Value	Body material	Outlet ranges (Examples*)	Seat material	Inlet/outlet conn.	Porting configuration	None venting
MF-230	1	S	10S	K	04N	N	NV
MF-230	1 – 1.0	S – 316SS	01S: 0-1 bar/0-15 psi 02S: 0-2 bar/0-29 psi 05S: 0-5 bar/0-73 psi 10S: 0-10 bar/0-145 psi	T – Teflon (Max inlet: 10bar/150psi) F – FEP (Max inlet: 50bar/725psi) K – PCTFE (Max inlet: 230bar/3300psi)	04N – ½" NPT 04B – ½" BSP	Check Page 47 = Gauge Port locations	NV

* Maximum inlet pressure can be set to specific requirements

PERFORMANCE CHARTS

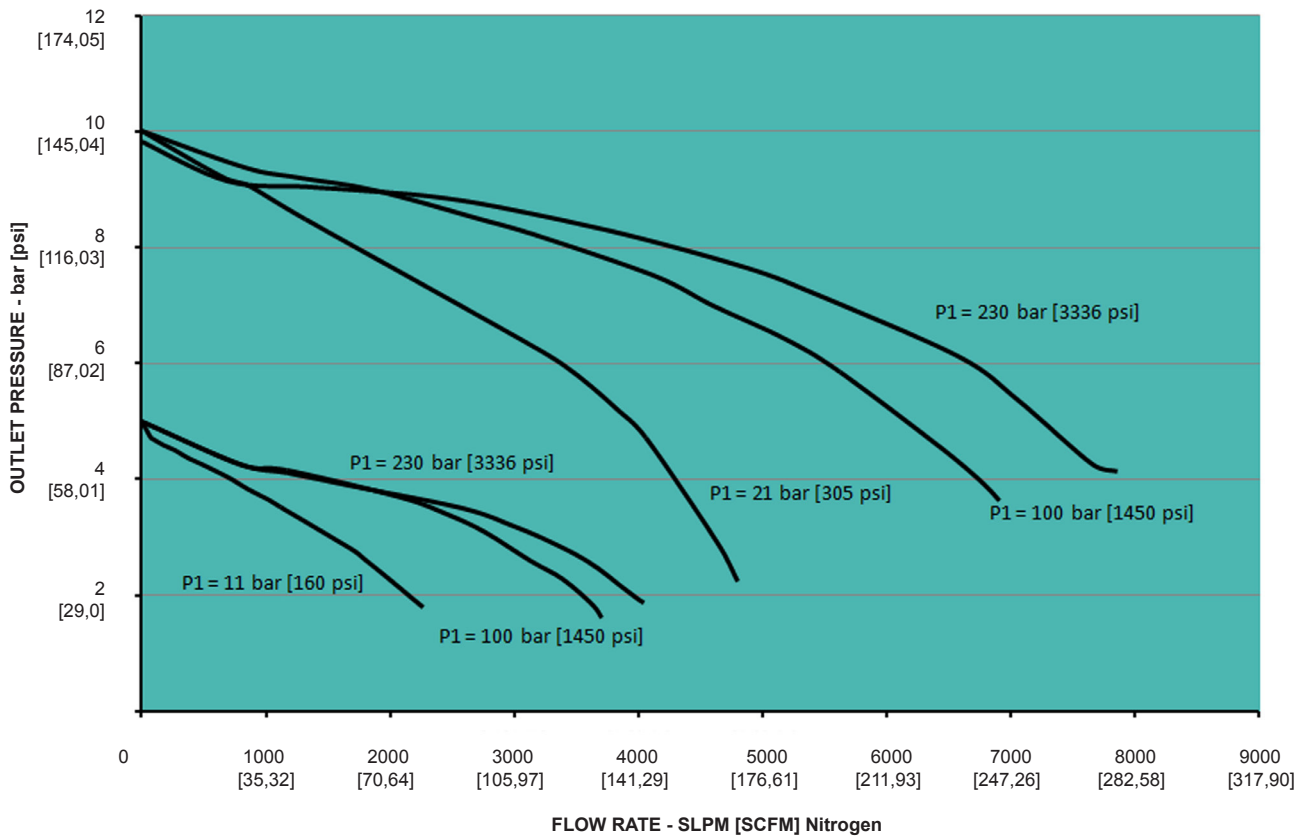

INSTALLATION DIMENSIONS:

